

Description

- High performance with differential mode choke.
- Good low frequency attenuation.
- Good performance for inverter and kinds of speed motor apparatus, which meet the RFI electromagnetic compatibility of Euro standards.
- Welcome for customized products.

Electrical Schematic:

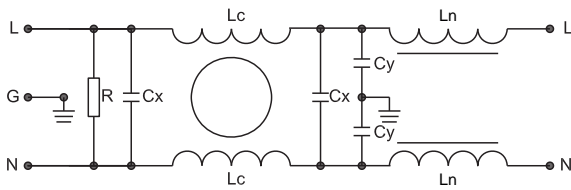

Fig 1





Typical Applications :

- Inverter.
- Machinery.
- Frequency drive device.
- Electronic and electrical equipment.
- Building automation.
- Electronic data processing equipment.
- Industrial applications.
- Various noisy applications requiring good filter performance

Specification :

Rated Voltage:	120/250VAC
Operating frequency:	50/60Hz
Rated Current:	6A~25A
Temperature range :	HPF 25/085/21
Test voltage(1min):	
Line to ground :	2000VAC
Line to Line :	1450VDC
Leakage Current(Max):	
Line to Ground :	@250VAC/50Hz

Data table:

MCT P/N:	Rated Current: A	Rated Voltage: V	Leakage Current: mA	Input/Output connections	Electrical Schematic:	Dimension
MCT2S9-6-6	6	120/250	0.5		1	51
MCT2S9-10-6	10	120/250	0.5		1	51
MCT2S9-16-6	16	120/250	1.0		1	52
MCT2S9-25-6	25	120/250	1.0		1	52

Dimension: unit :mm

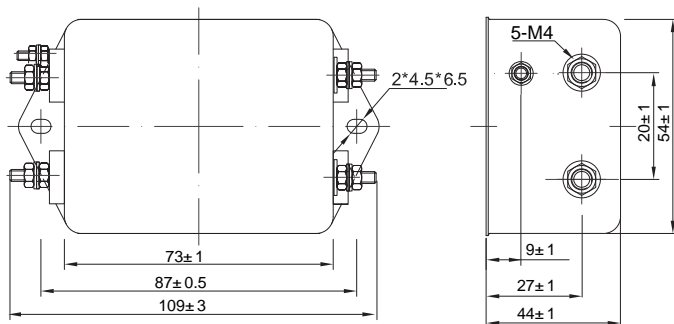

Fig 51

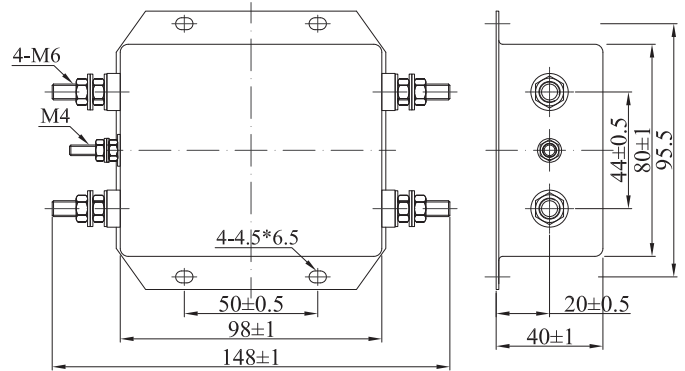
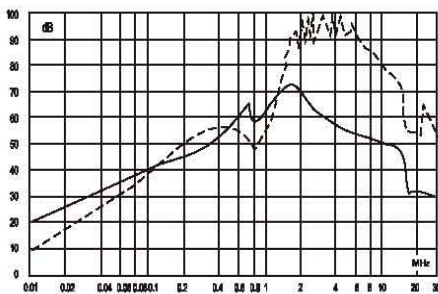

Fig 52

Insertion Loss in dB:

(Measured in 50Ω system , as IEC/CISPR NO.17)

----- Differential Mode
———— Common Mode



6A

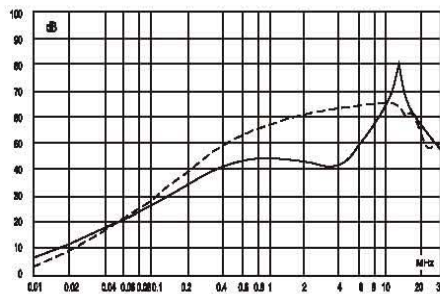

10A

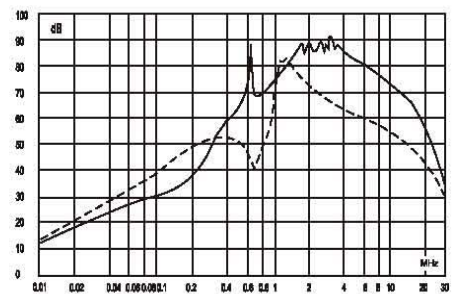

16A

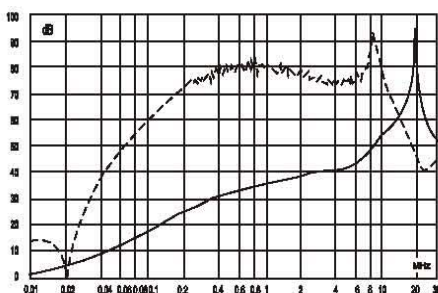

25A