

Description

- General purpose filtering performance.
- Easy and fast chassis mounting.
- Rated currents from 1 to 10A
- Low leakage current and high quality components ensure the safety and reliability of filters.
- Various terminal options: faston/screw/wire. Welcome customized various types of products.

Typical Applications :

- Electrical and electronic equipment.
- Office automation equipment.
- Consumer goods.
- Datacom equipment.
- Household equipment.
- Medical equipment

Electrical Schematic:

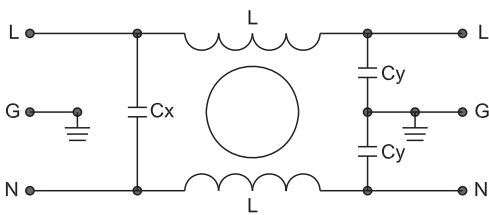

Fig 1

Specification :

Rated Voltage:	120/250VAC
Operating frequency:	50/60Hz
Rated Current:	1A~10A
Temperature range :	HPF 25/085/21
Test voltage(1min):	
Line to ground :	2000VAC
Line to Line :	1450VDC

Insertion Loss in dB:

(Measured in 50Ω system , as IEC/CISPR NO.17)

----- Differential Mode  
———— Common Mode

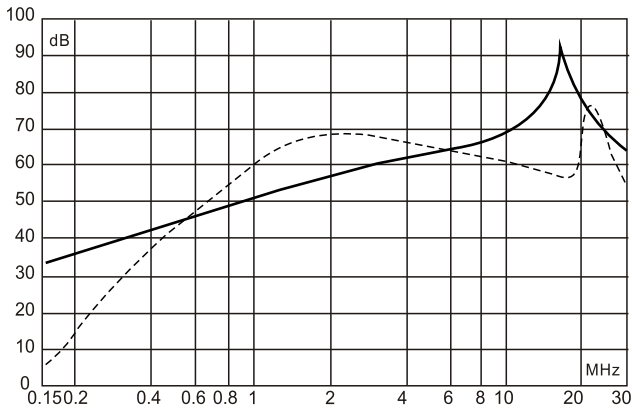

1A

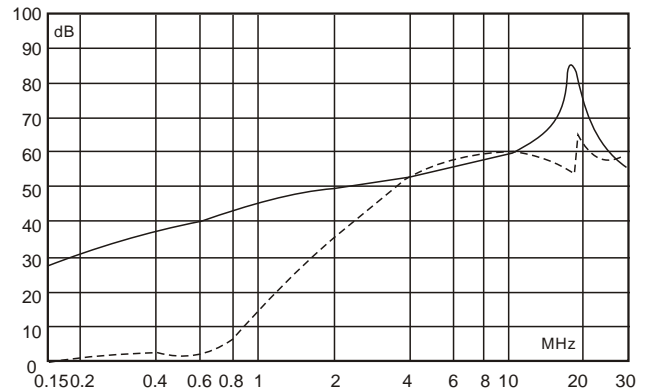

3A

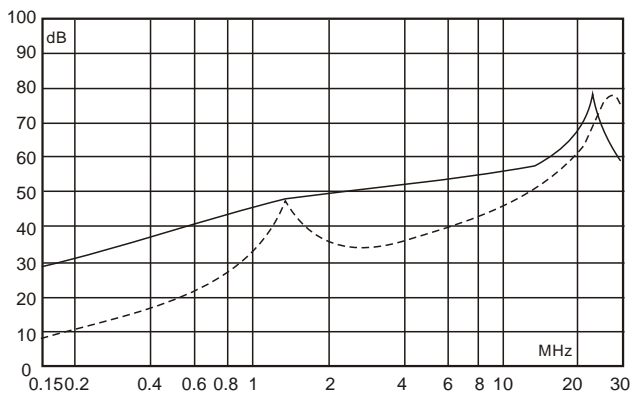



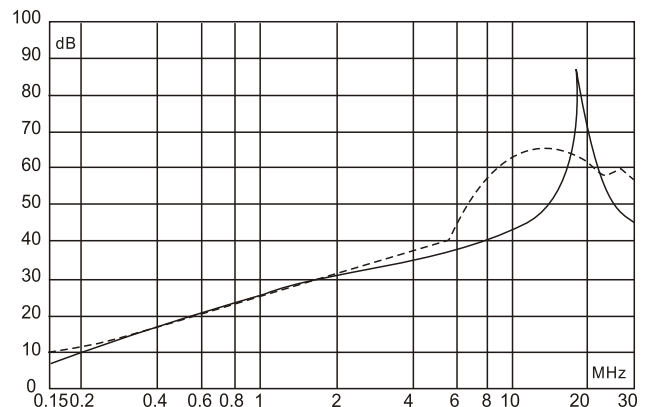















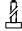

6A



10A

Data table:

MCT P/N:	Rated Current: A	Rated Voltage: V	Leakage Current: mA	Input/Output connections	Electrical Schematic:	Dimension
MCT2S1-1-1	1	120/250	0.5		1	34
MCT2S1-3-1	3	120/250	0.5		1	34
MCT2S1-6-1	6	120/250	0.5		1	34
MCT2S1-10-1	10	120/250	0.5		1	34
MCT2S1-1-3	1	120/250	0.5		1	36
MCT2S1-3-3	3	120/250	0.5		1	36
MCT2S1-6-3	6	120/250	0.5		1	36
MCT2S1-10-3	10	120/250	0.5		1	36
MCT2S2-1-1	1	120/250	0.5		1	35
MCT2S2-3-1	3	120/250	0.5		1	35
MCT2S2-6-1	6	120/250	0.5		1	35
MCT2S2-10-1	10	120/250	0.5		1	35
MCT2S2-1-3	1	120/250	0.5		1	37
MCT2S2-3-3	3	120/250	0.5		1	37
MCT2S2-6-3	6	120/250	0.5		1	37
MCT2S2-10-3	10	120/250	0.5		1	37
MCT2S3-1-1	1	120/250	0.5		1	38
MCT2S3-3-1	3	120/250	0.5		1	38
MCT2S3-6-1	6	120/250	0.5		1	38
MCT2S3-10-1	10	120/250	0.5		1	38

Dimension: unit :mm

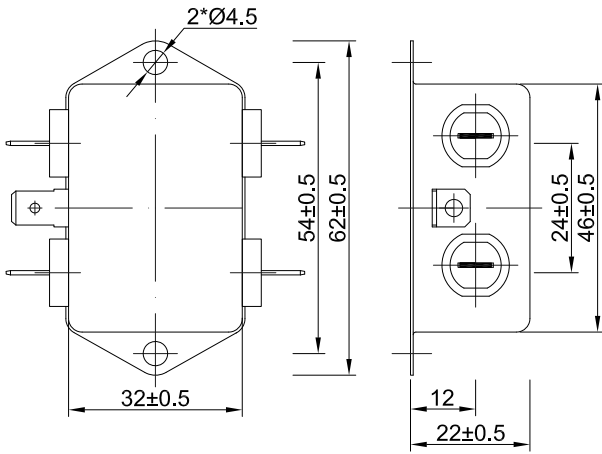

Fig 34

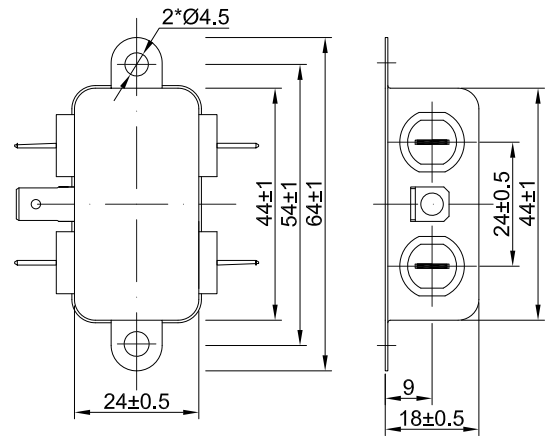

Fig 35

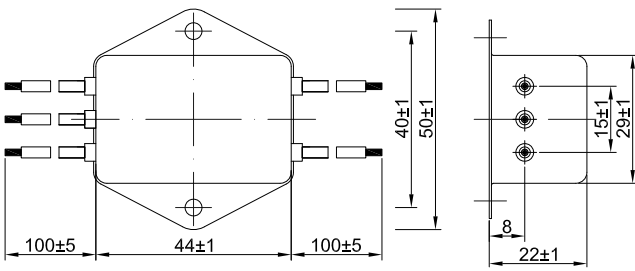

Fig 36

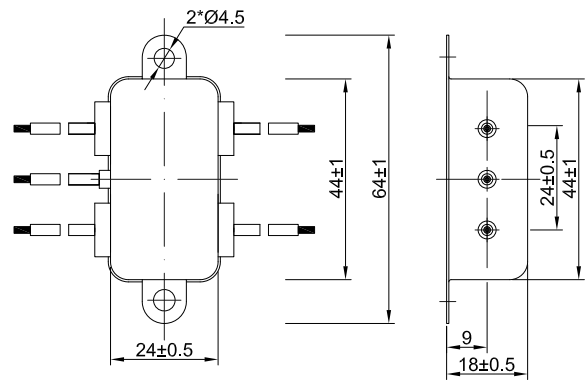

Fig 37

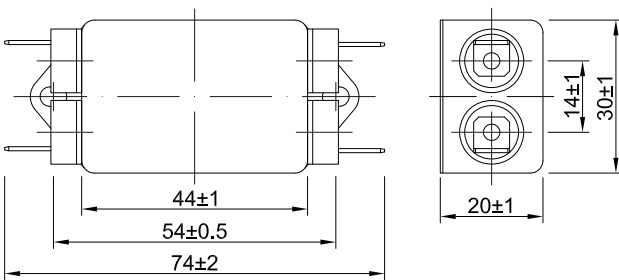

Fig 38